

Art. no. 50012997

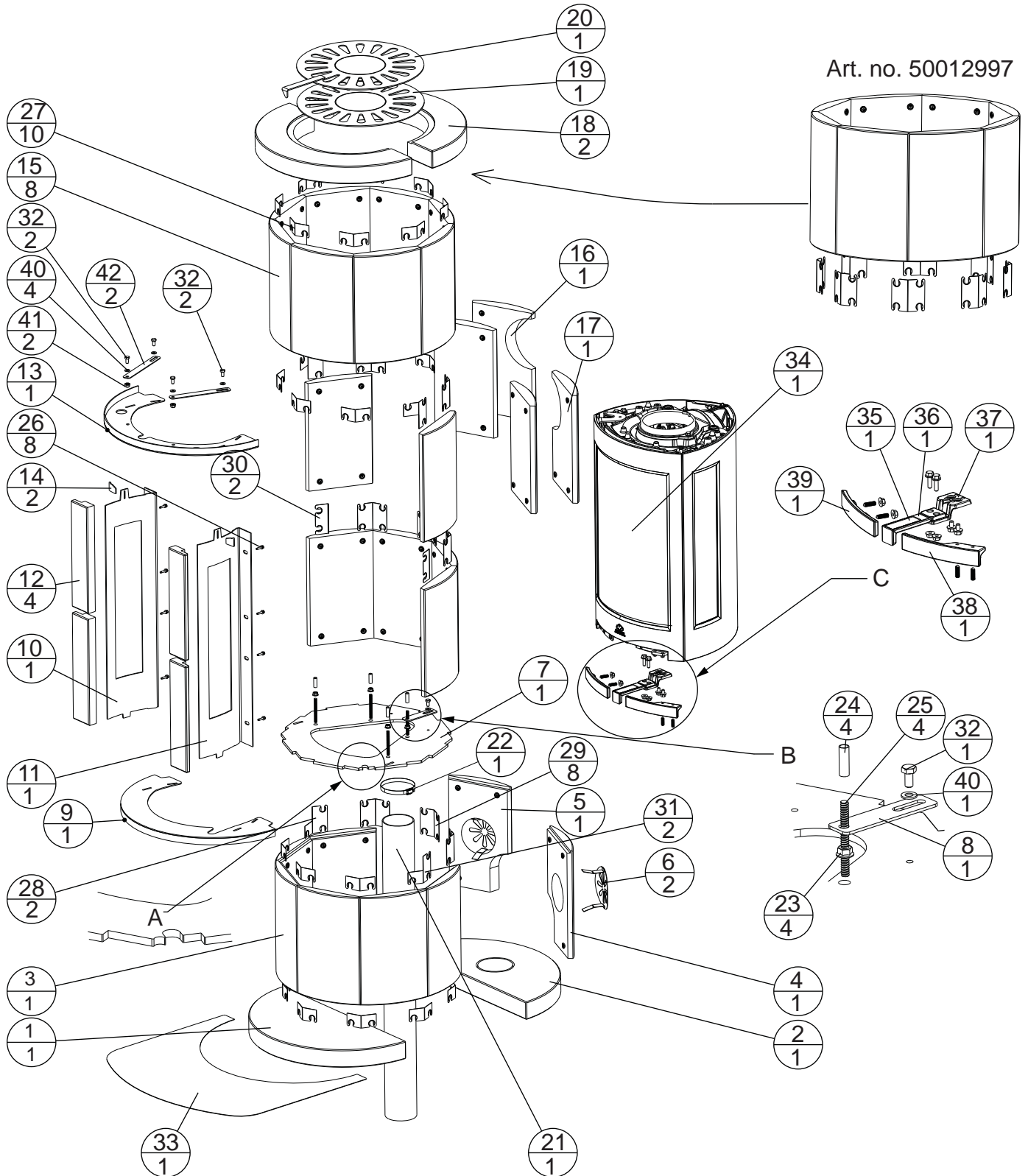

Partlist, Jøtul F 162 Advance

Jøtul AS
Fredrikstad, Norway

Draw. no: Sheet 1/1
900224-P01

Date:
21.04.2017

Jøtul FS 162 Advance

Jøtul FS 162-158cm/F 370 Advance-cat.no. 21051700

Jøtul FS 162-195cm/F 370 Advance-cat.no. 21051701

Pos. no.	Qty	Cat. No.	Spareparts	Consist of	Benevnelse	Description
34	1	30050843			Jøtul F 370 Advance, BP	Jøtul F 370 Advance, BP
	1	10026251		1,2,3,4,5,12,15,16,17,18,26,27,28,29,30,31	Klebersten sett	Soap stone kit
	1	10051251		6,7,8,9,10,11,13,14,19,20,21,22,23,24,25,32,40, 41,42	Ståldeler sett	Steel part kit
	1	51051446		35,36,37,38,39	Handtak komplett FS84/FS162 ADV	Handles for surround FS84/FS162 ADV
1	1	10026203	10026203		Bunnsten	Bottom stone
2	1	10026204	10026204		Bunnsten m/utslagsåpning	Bottom stone w/hole
3	6	10026206	10026206		Sidesten bunnlag	Sidestone bottom layer
4	1	10026201	10026201		Sidesten m/konveksjonshull, H	Sidestone w/convectionhole, R
5	1	10026205	10026205		Sidesten m/konveksjonshull, V	Sidestone w/convectionhole, L
6	2	10046733	10046733		Deksel konveksjonshull sort lakk	Cover convection hole black paint
7	1	10046737	10046737		Bæreplate sort lakk	Support plate black paint
8	1	10026222	10026222		Låsebrakett	Locking bracket
9	1	10046734	10046734		Dekkplate nedre sort lakk	Coverplate, lower black paint
10	1	10051219	10051219		Sidekassett , V sort lakk	Sidecassette, L black paint
11	1	10051220	10051220		Sidekassett, H sort lakk	Side cassette, R black paint
12	4	10026207	10026207		Dekorsten	Decor stone
13	1	10046735	10046735		Dekkplate øvre sort lakk	Coverplate, upper black paint
14	2	10046732	10046732		Kile sort lakk	Wedge black paint
15	16	10026200	10026200		Sidesten	Sidestone
16	1	10026198	10026198		Sidesten røkkuttak, V	Sidestone smoke outlet, 1
17	1	10026202	10026202		Sidesten røkkuttak, H	Sidestone smoke outlet, R
18	2	10026199	10026199		Toppsten	Top stone
19	1	10046736	10046736		Ventil plate sort lakk	Valve plate black paint
20	1	10046738	10046738		Ventil sort lakk	Valve black paint
21	1	10026181	10026181		Fleksislange Ø100x1000 BP	Flex Hose Ø100x1000 BP
22	1	10026180	10026180		Slangeklemme Ø90-110	Hose Clamp Ø90-110
23	4	10023667	10023667		Mutter 6K M/FLENS m8	Nut hex cap fl M8
24	4	10025839	10025839		Distansehylse Ø10xØ8,1x31	Spacer tube Ø10xØ8,1x31
25	4	10026236	10026236		Gjengestang M8	Bolt M8x80
26	8	10026221	10026221		Skrue spesial for dekorsten	Screw for decor stone
27	22	10026211	10026211		Festebrakett enkel m/vinkel	Mounting bracket simple w/angle
28	2	10026213	10026213		Festebrakett 3/2, V	Mounting bracket, 3/2, L
29	9	10026210	10026210		Festebrakett dobbel m/vinkel	Mounting bracket, double w/angle
30	2	10026208	10026208		Festebrakett enkel	Mounting bracket, simple
31	2	10026212	10026212		Festebrakett 3/2, H	Mounting bracket, 3/2, R
32	5	10023465	10023465		Skrue sekskant M8X16 ST8,8	Screw M8x16 ST8,8
35	1	10050647	10050647		Plate for valve	Plate for valve
36	1	12050959	12050959		Ventilhendel, omramning	Valvehandle, surround
37	1	12050960	12050960		Mellomstykke ventilhendel	Middle part valvehandle
38	1	12050961	12050961		Handtak, omramning	Handle, surround
39	1	12050962	12050962		Handtak dummy omramning	Handle dummy surround
40	2	10038500	10038500		Låsemutter M8 M/FL	Locking Nut M8
41	5	10023568	10023568		Skive Ø8,4XØ17X1,6	Sleeve Ø8,4XØ17X1,6
42	2	10052224	10052224		Brakett låsing oppe	Bracket fasten upper

Jøtul FS 162 Advance

Jøtul FS 162-158cm/F 370 Advance-cat.no. 21051700

Jøtul FS 162-195cm/F 370 Advance-cat.no. 21051701

<i>Pos. no.</i>	<i>Qty</i>	<i>Cat. No.</i>	<i>Spareparts</i>	<i>Consist of</i>	<i>Benevnelse</i>	<i>Description</i>
Jøtul FS 162 - ADD HEIGHT 36,5CM 50012997						
15	8		10026200		Sidesten	Sidestone
29	8		10026210		Festebrakett dobbel m/vinkel	Mounting bracket, double w/angle
Tilleggsutstyr / Optional extra Jøtul FS 162						
33	1		51046806		Gulvplate FS 162	Floor Plate FS 162
-	1		51013631		Senterforskyver Ø150x60	Center Offset Ø150x60
-	1		51012164		Utelufttilkobling Ø100	Outside air kit Ø100mm
<i>Draw. no: 900224-P01</i>						